

STC-AR0341C-G2

Supertek 3MP GMSL2F Camera Module



SPECIFICATION

Sensor	ONSEMI 2.95MP AR0341 RGG B
ISP	/
Image Size	1/3.6 inch CMOS
Output Pixels	1920H x 1536V
Pixel Size	2.1um * 2.1um
Frame Rate	Max 60fps
HDR Support	Yes
Output data	RAW 12
Serializer	MAXIM MAX96717F
Camera Interface	GMSL2
Power Supply	9-16V POC
Current	<200mA@12VDC
Connector	Amphenol Fakra (Z Code)
Operating temp.range	-40~+85°C
Waterproof	Refer to the lens
Dimension	W: 24mm, L: 24mm, H: 16.5mm
Weight	<50g

For more information relating to cameras, please send us email via sales@supertekmodule.com, or visit our website www.supertekmodule.com

Model and Lens							
Model	HFOV	VFOV	F.No	EFL	Waterproof	Max Optical Distortion	Process specification
STC-AR0341C-G2F-H190X	196°	160°	1.7	1.02mm	IP67	-134%	M12

Serializer	
Model	Max96717F
I2C Address	0x80 (8bit address)
Rate	GMSL2 (3G bps)

Sensor	
Model	AR0341
I2C Address	0x20 (8bit address)
Frame Sync	Controlled by Max96717F MFP7
Reset	Controlled by Max96717F MFP0
Error	Controlled by Max96717F MFP5

Features

1. Output RAW data
2. Vehicle Protection Registration
3. Support external triggering
4. Multi Camera Synchronization

Block Diagram

系统框图

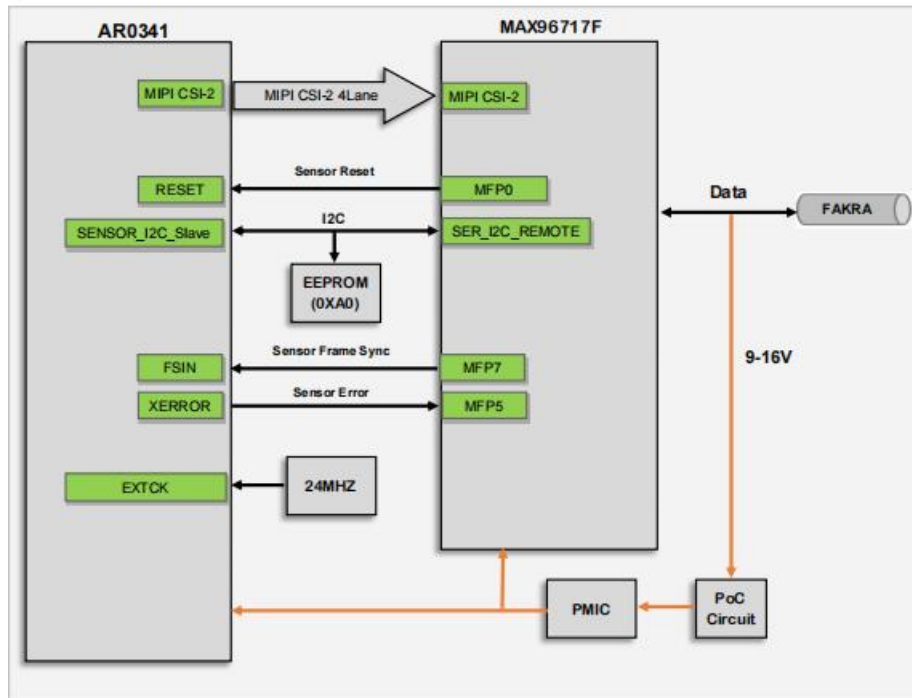

系统框图

PRODUCT DIMENSION

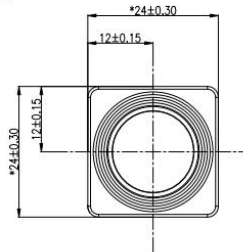

Front View

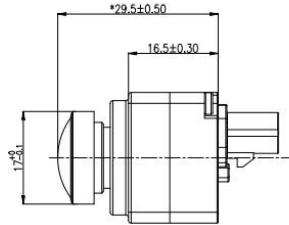

Side View

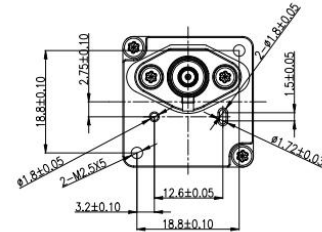

Rear View

Note:



1. This icon indicates the imaging direction is positive.